

THE WILLOW - 4 BEDROOM HOUSE - 3 TERRACE BLOCK - GROUND FLOOR

ROOM DIMENSIONS

THE WILLOW - 4 BED

LOUNGE	2.89m x 5.21m	9'5" x 17'1"
KITCHEN/DINING	5.32m x 3.00m	17'5" x 9'10"
CLOAKS	1.02m x 2.04m	3'4" x 6'8"

* MAXIMUM ROOM DIMENSIONS

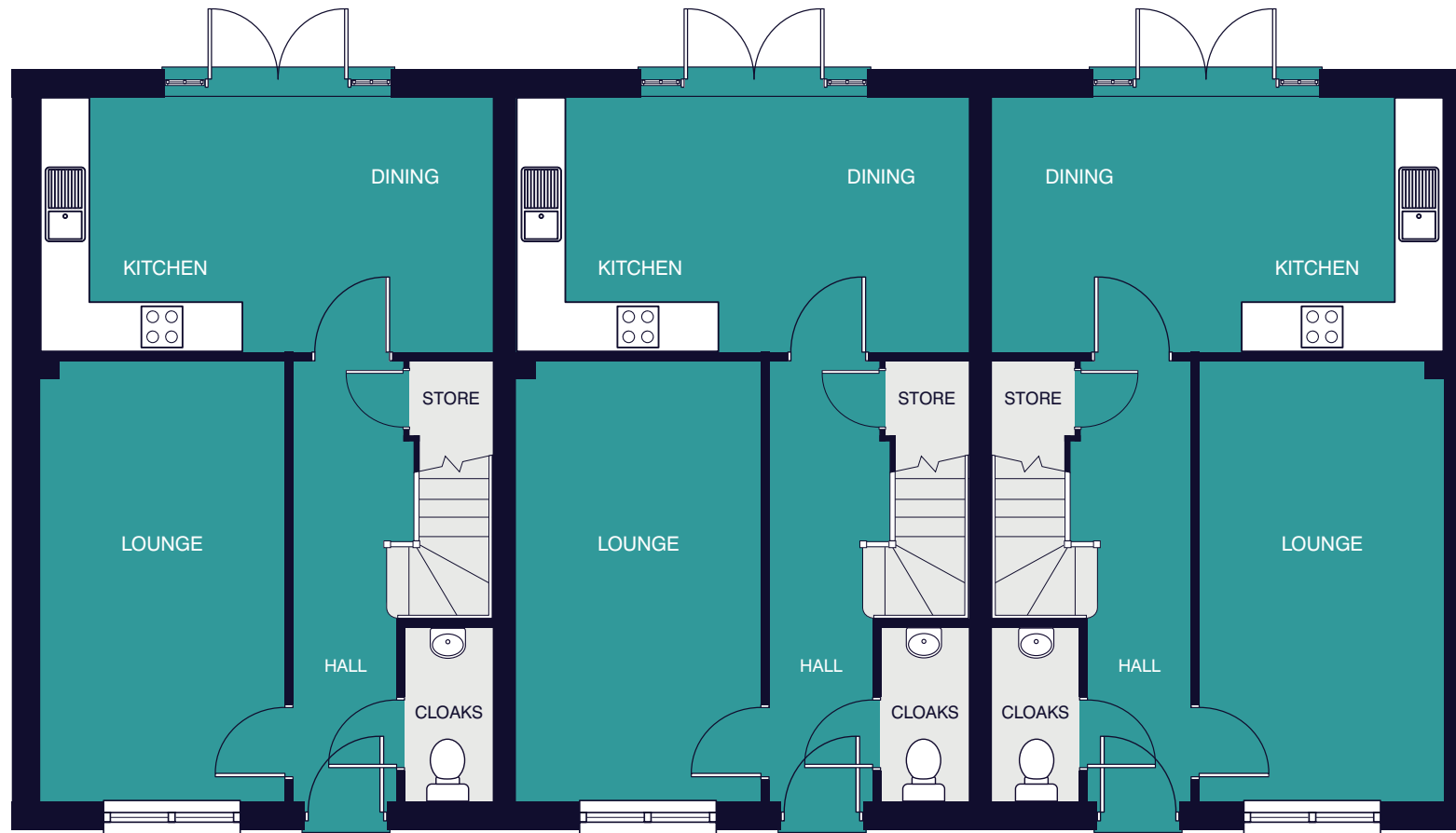

PLOT 44

PLOT 43

PLOT 42